



UNDERSTANDING THE BRIEF

Millston Postcards

5 GUIDING PRINCIPLES

1. Every part of the building is critical for the cultural experience
2. Mixed collections: inspiring cross-pollination of ideas
3. The construction process as a further opportunity to fund the ladder
4. Creative hierarchy to constructing new space - Reuse, Re-purpose, Re-build
5. A design style suited to a time and place

THE FIRST STRAW MAN

INTUITIVE RE-ORDERING OF THE SPACE

'DO THE BEST FOR THE MOST'
JOHN PASSMORE EDWARDS

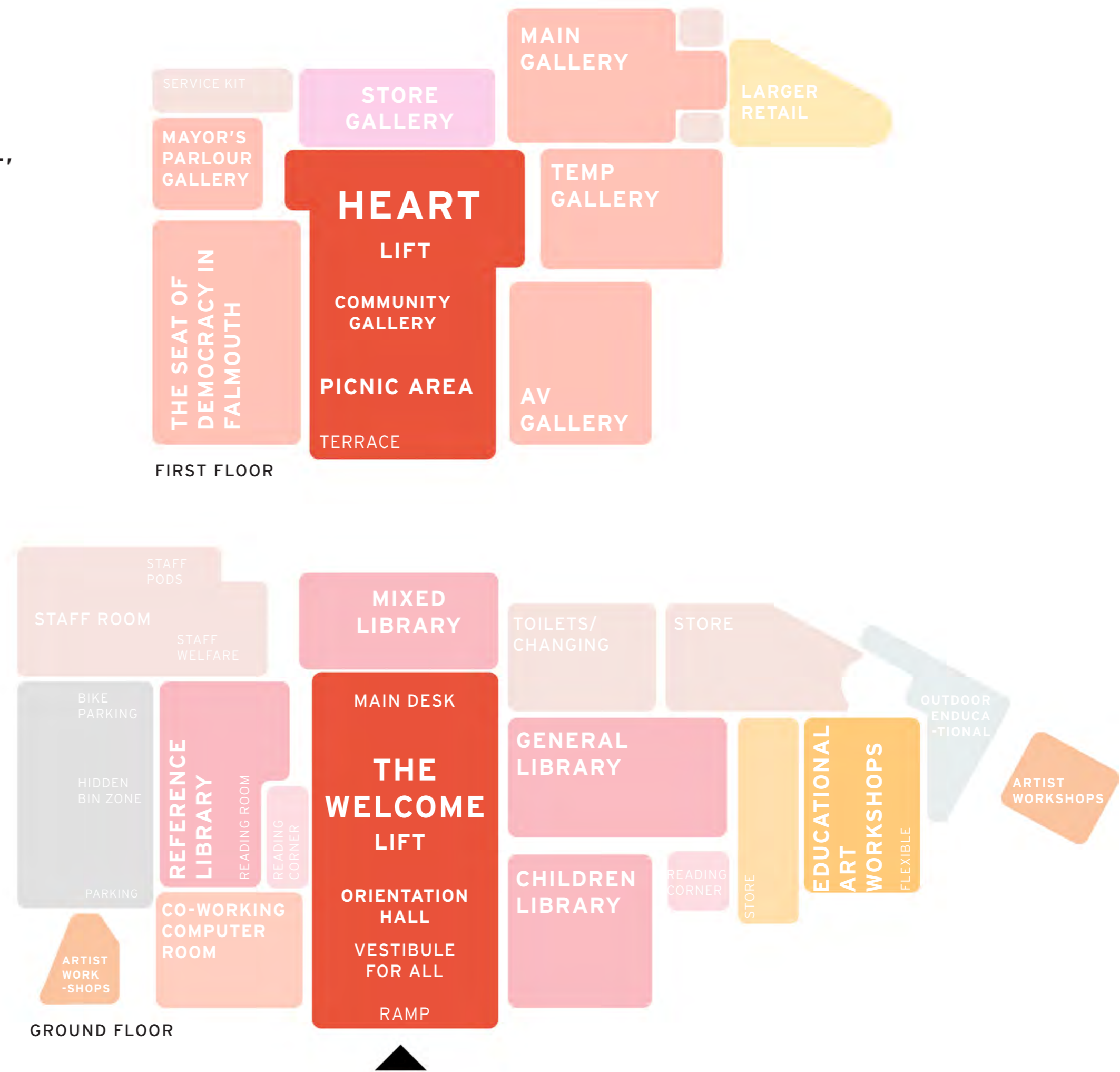

THE FIRST STRAW MAN

INTUITIVE RE-ORDERING OF THE SPACE

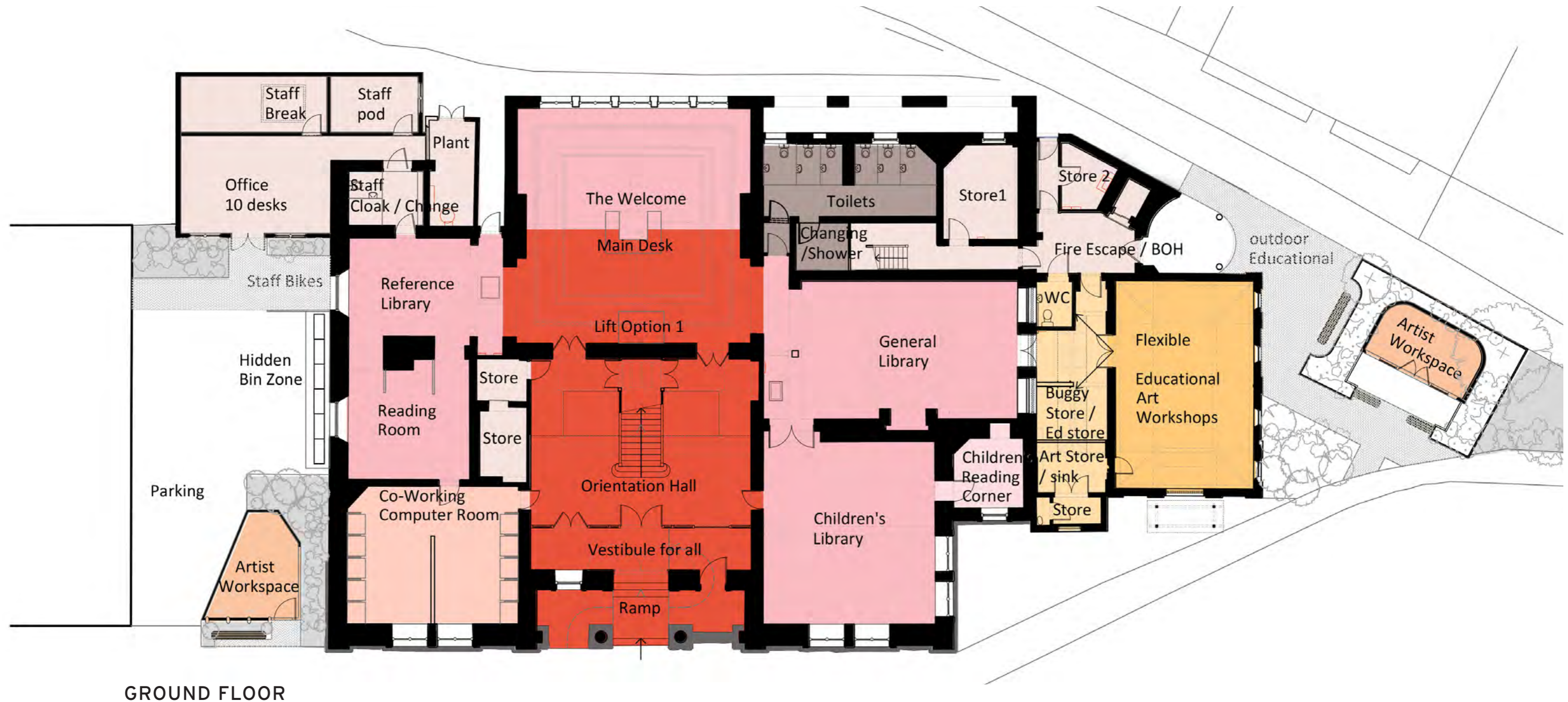

THE FIRST STRAW MAN

INTUITIVE RE-ORDERING OF THE SPACE

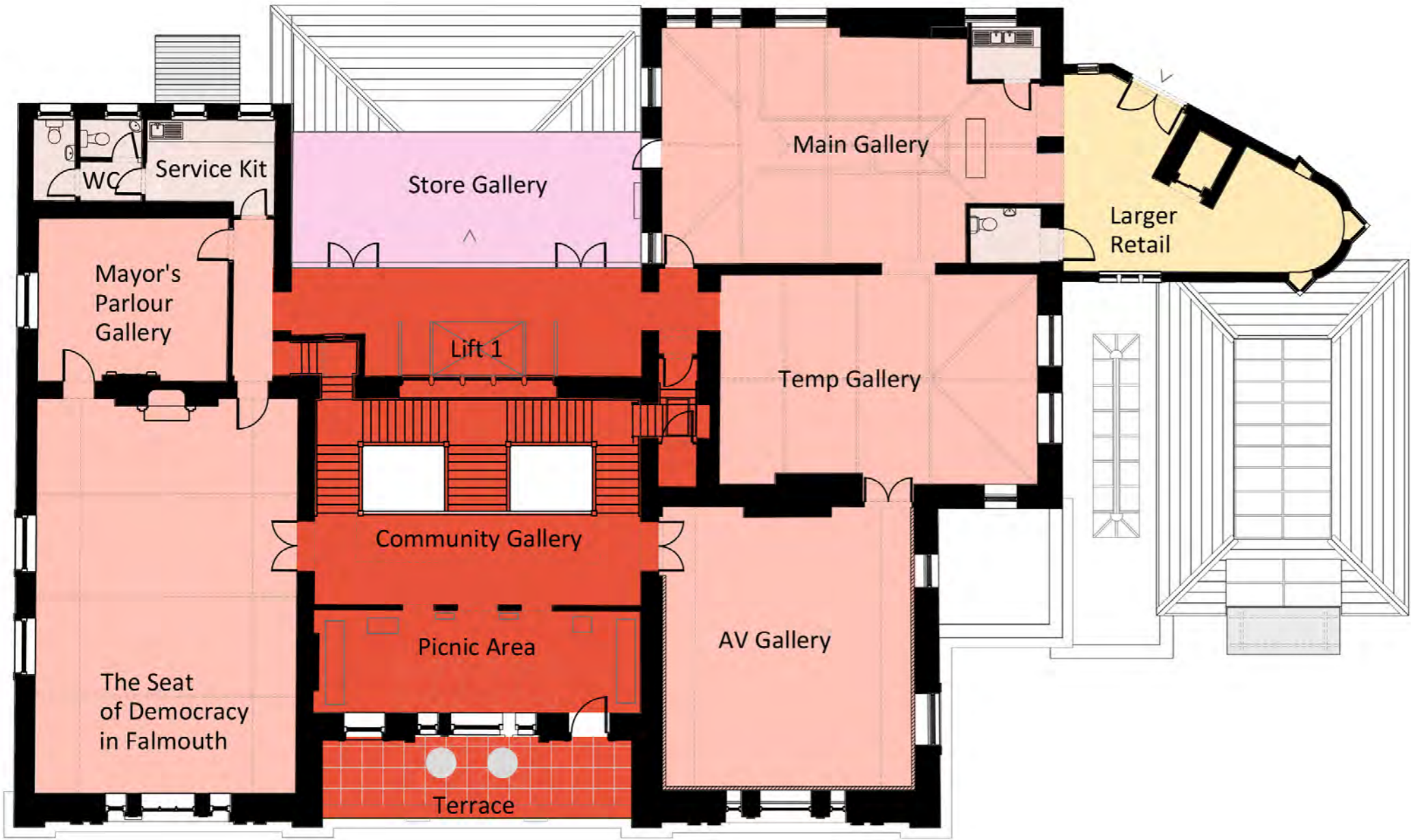

THE FIRST STRAW MAN

A WELCOME FOR ALL

'DO THE BEST FOR THE MOST':

JOHN PASSMORE EDWARDS

- ACCESSIBILITY AND INCLUSION
- CONNECT TO ENTIRE SPECTRUM
- EQUITABLE AND OBVIOUS
- NEW LIGHT FILLED LIFT CORE AT CENTRE OF PLAN

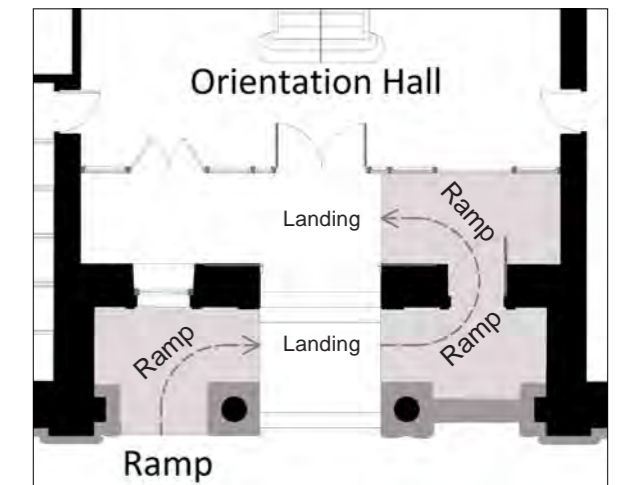

THE FIRST STRAW MAN

ENTRANCE FOR ALL

'DO THE BEST FOR THE MOST': JOHN PASSMORE EDWARDS

- UPON ENTERING, LEVEL ACCESS ROUTES TO THE HEART
- FANLIGHTS REOPENED AS WAYFINDING
- COMMUNITY GLASS RELOCATED TO GIVE VIEW INTO STORES



THE FIRST STRAW MAN

ENTRANCE FOR ALL

- NOT AUSTERE AND SCARY
- COLOURED GLASS OR VINYL ADDED TO THE GLAZED SCREEN WILL MAKE THE SPACE WARMER AND MORE WELCOMING



THE FIRST STRAW MAN

A WELCOME FOR ALL

- THE WELCOME SPACE IS AT THE HEART OF THE BUILDING. IT IS A MIXED SERVICE AREA WITH AN INTRODUCTION TO THE LIBRARY, THE GALLERIES AND THE NEW SERVICES ON OFFER.
- SHOWCASES THE WHOLE RANGE OF ACTIVITIES THAT A VISITOR CAN ENGAGE WITH
- INCLUDES A SPACE FOR AN EVER CHANGING EXHIBITION



THE FIRST STRAW MAN

A WELCOME FOR ALL

- A SINGLE SHELF - THINK OF THE BOOKSHELF AS A MULTI-FUNCTIONAL, SINGLE PIECE OF FURNITURE
- WITH SEATING, OBJECT CASES, ART DISPLAY, SIGNAGE, TABLES AND SHELVING
- BRINGING TOGETHER ALL THE FUNCTIONS OF THE BUILDING IN ONE OBJECT.



THE FIRST STRAW MAN

HERITAGE AT THE FORE

- HIGHLIGHT THE EXISTING - THIS FLEXIBLE SPACE IS DESIGNED AROUND THE BEAUTY OF THE EXISTING.
- WE HAVE INTRODUCED LIGHTING TO MATCH THE LOBBY AND USED LIGHT TONES TO ACCENTUATE THE MOULDINGS. A TRUE PIECE OF CONSERVATION.



A BUILDING THAT WORKS

- VISITOR FLOW CORRECTED
- EQUITABLE EXPERIENCE FOR ALL
- FABRIC AND ROOF REPAIRS
- THERMAL ENVELOPE UPGRADE
- MEP SERVICES OVERHAUL
- SUSTAINABILITY & NET ZERO TARGETS

**ALIGNED WITH MEND FUNDING, 2030 NET ZERO GOAL
AND CORNWALL COUNCIL PLANNING REQUIREMENTS:**

ENERGY MODELLING AND M&E STRATEGIES TO EVIDENCE CARBON REDUCTION
AND LIFECYCLE SAVINGS.

LOW-CARBON PLANT STRATEGY: TRANSITION FROM GAS BOILERS TO HIGH-EFFICIENCY ASHPS, WITH FEASIBILITY STUDIES FOR ACOUSTIC AND SPATIAL CONSTRAINTS.

FABRIC-FIRST & PASSIVE DESIGN: MAXIMISE NATURAL VENTILATION AND INSULATION UPGRADES BEFORE ACTIVE SYSTEMS ARE SPECIFIED.



HERITAGE-SENSITIVE DESIGN: DISCREET,
ZONED HEATING/VENTILATION, NON-INVASIVE
CONTAINMENT AND COORDINATED ROUTING.

SMART ELECTRICAL UPGRADES: IMPROVE CAPACITY,
PROVIDE ADAPTABLE LIGHTING, POWER AND CONTROLS.

CIRCULAR ECONOMY APPROACH: SELECT LOW-IMPACT, MAINTAINABLE SYSTEMS AND MINIMISE SINGLE-USE PLASTICS IN DELIVERY.